

CS30 A

Open series

Matchcode

CS30 **A** **200** **R075**
 Inner height Open series Inner width Bending radius

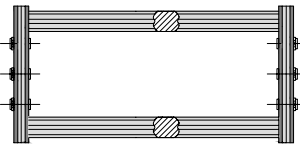
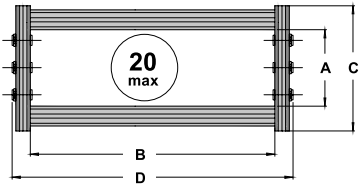

CS30 A	A	B _{min} – B _{max}	C	D _{min} – D _{max}	R
<i>Model</i>	<i>Inner height (mm)</i>	<i>Inner width (mm)</i>	<i>Outer height (mm)</i>	<i>Outer width (mm)</i>	<i>Bending radius</i>
CS30 A	30	50 – 500	50	66 – 516	75, 150

- L Calculation of the chain length
- HM Travel distance
- X Mounting height
- Y Radius length
- H Pitch

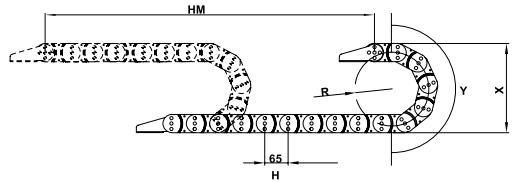

$L = HM / 2 + Y$	$X = R \times 2 + C$	$Y = R \times \pi$
------------------	----------------------	--------------------

Bending radius	75	150
H (mm)	65	65
X (mm)	215	365
Y (mm)	236	471

The closed type product radius is started from R150

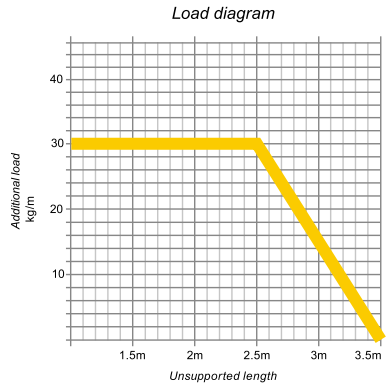

CS30 B

Special designed aluminium steel series

Matchcode

CS30 **B** **200** **R150**
 Inner height Special designed series Inner width Bending radius

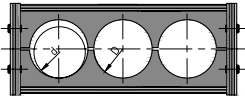

D_{max} 30 mm

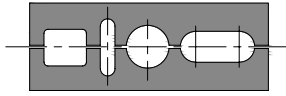

Hole stay inserts with horizontal and vertical slots

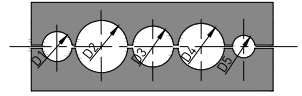

Hole stay inserts with individual holes



Available special designed for your cable and hose holes

CS30 B	A	$B_{min} - B_{max}$	C	$D_{min} - D_{max}$	R
Model	Inner height (mm)	Inner width (mm)	Outer height (mm)	Outer width (mm)	Bending radius
CS30 B	—	50 – 500	50	66 – 516	75, 150

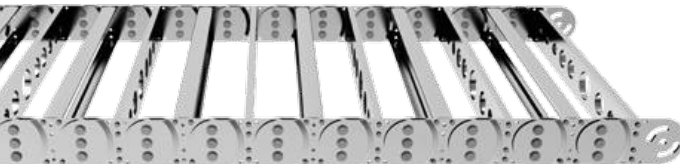

CS30 K

Closed series

Matchcode

CS30 **K** **200** **R150**
 Inner height Closed series Inner width Bending radius

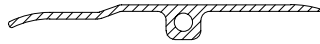
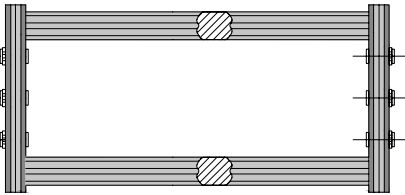

Plastic glides for longer applications

CS30 K	A	B _{min} – B _{max}	C	D _{min} – D _{max}	R
Model	Inner height (mm)	Inner width (mm)	Outer height (mm)	Outer width (mm)	Bending radius
CS30 K	30	50 – 500	50	66 – 516	150



Vertical and horizontal separator

CS30 SP

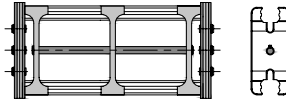
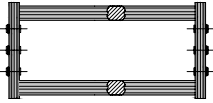

Horizontal separator application

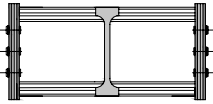

Plastic vertical separator application

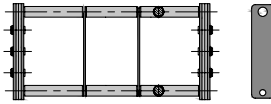

Steel vertical separator application



Steel end bracket assembly dimensions

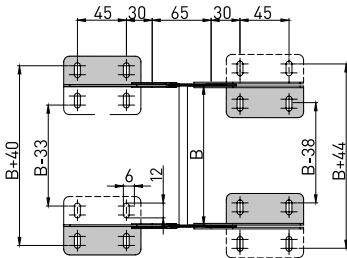

You will find the 'B' dimension from model table.

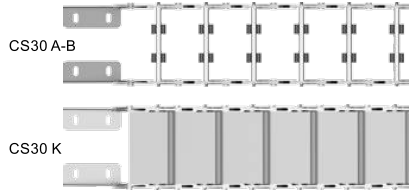

Steel end bracket assembly

CS30 M

